

RIGHT INLET - (JR)

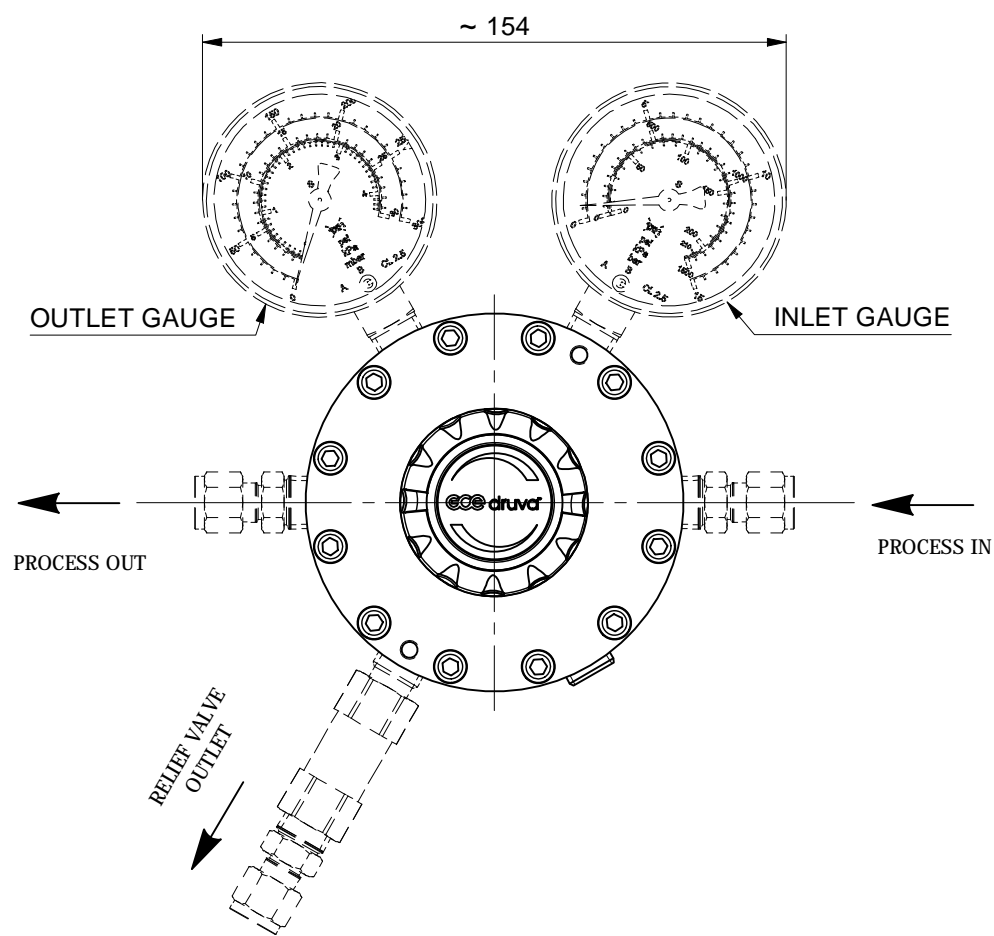

LEFT INLET - (JL)

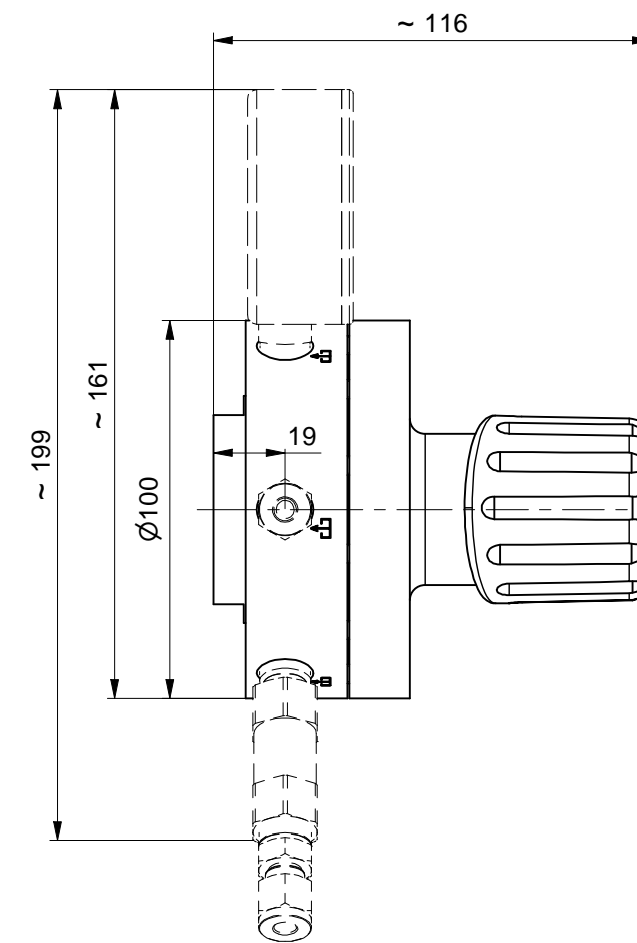
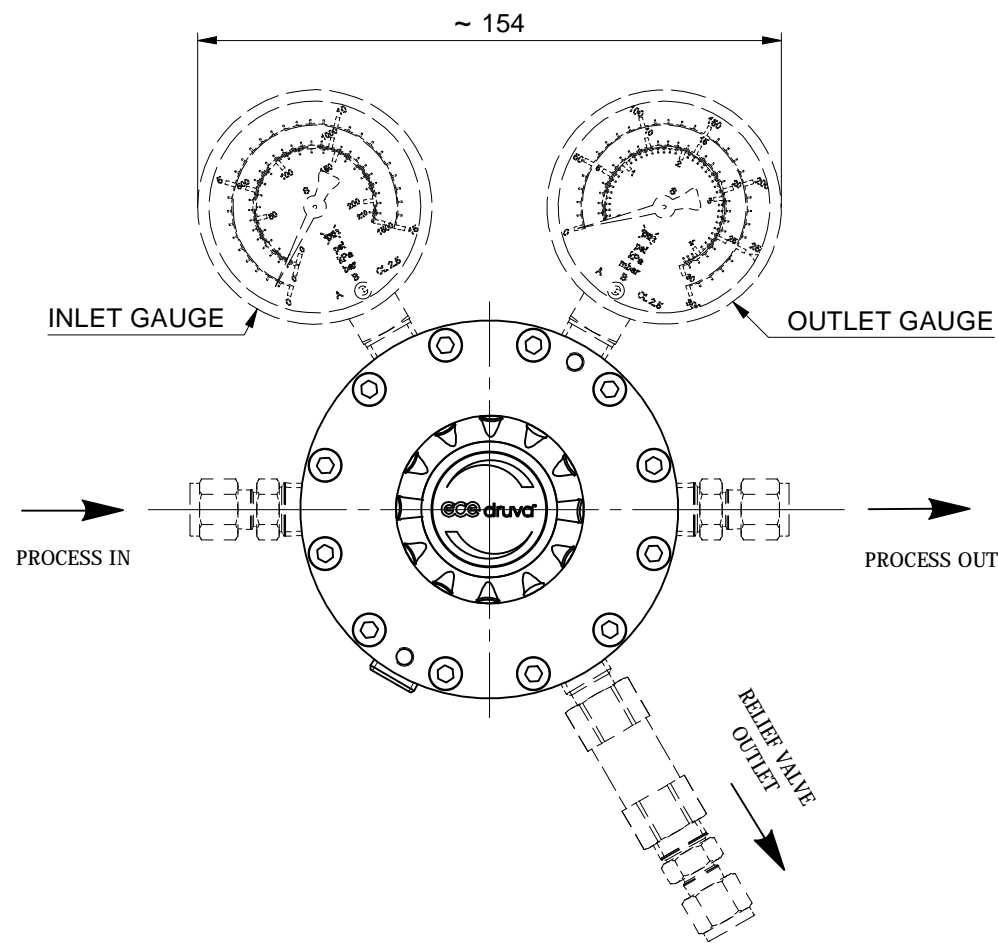

ORDERING INFORMATION

LPBPVS JX XX XX XX XX XXXX XXXX XX XXXX

PORTING CODE: R - RIGHT INLET L - LEFT INLET	RELIEF CONNECTION: 0001 - WITHOUT (PLUGGED) MORE VERSIONS ON LIST OF CONN.
INLET PRESSURE: D1 - 12 BAR E1 - 40 BAR	SAFETY DEVICE: 00 - WITHOUT (NPT1/4 INCH FEMALE) 01 - WITHOUT (PLUGGED) RV - PRESSURE RELIEF VALVE (FOR OUTLET PRESSURE 1.3 BAR / 3 BAR)
OUTLET PRESSURE: A4 - 0,25 BAR A3 - 0,45 BAR A2 - 1,3 BAR BX - 3 BAR (ONLY FOR INLET PRESSURE 40 BAR)	PROCESS OUTLET CONNECTION: N14F - NPT1/4 INCH FEMALE M03S - COMPRESSION FITTING 3MM SS M06S - COMPRESSION FITTING 6MM SS M08S - COMPRESSION FITTING 8MM SS MORE VERSIONS ON LIST OF CONNECTIONS
INLET GAUGE TYPE: 00 - WITHOUT (NPT1/4 INCH FEMALE) 01 - WITHOUT (PLUGGED) BT - BOURDON TUBE	PROCESS INLET CONNECTION: N14F - NPT1/4 INCH FEMALE M03S - COMPRESSION FITTING 3MM SS M06S - COMPRESSION FITTING 6MM SS M08S - COMPRESSION FITTING 8MM SS MORE VERSIONS ON LIST OF CONNECTIONS

OUTLET GAUGE TYPE: 00 - WITHOUT (NPT1/4 INCH FEMALE) 01 - WITHOUT (PLUGGED) BT - BOURDON TUBE

LIST OF CONNECTIONS

- N14F - NPT1/4 INCH FEMALE
- M03B - COMPRESSION FITTING 3MM BRASS
- M06B - COMPRESSION FITTING 6MM BRASS
- M08B - COMPRESSION FITTING 8MM BRASS
- M10B - COMPRESSION FITTING 10MM BRASS
- M12B - COMPRESSION FITTING 12MM BRASS
- M03S - COMPRESSION FITTING 3MM SS
- M06S - COMPRESSION FITTING 6MM SS
- M08S - COMPRESSION FITTING 8MM SS
- M10S - COMPRESSION FITTING 10MM SS
- M12S - COMPRESSION FITTING 12MM SS
- IX2B - COMPRESSION FITTING 1/8" BRASS
- IX4B - COMPRESSION FITTING 1/4" BRASS
- IX6B - COMPRESSION FITTING 3/8" BRASS
- IX8B - COMPRESSION FITTING 1/2" BRASS
- IX2S - COMPRESSION FITTING 1/8" SS
- IX4S - COMPRESSION FITTING 1/4" SS
- IX6S - COMPRESSION FITTING 3/8" SS
- IX8S - COMPRESSION FITTING 1/2" SS
- H04B - HOSE NOZ MET 4.8 MM BRASS
- H06B - HOSE NOZ MET 6.4 MM BRASS
- H08B - HOSE NOZ MET 8.0 MM BRASS
- H04S - HOSE NOZ MET 4.8 MM SS
- H06S - HOSE NOZ MET 6.4 MM SS
- H08S - HOSE NOZ MET 8.0 MM SS

AVAILABILITY OF BRASS FITTINGS DEPENDING ON PRESSURE AND SIZE.
PAY ATTENTION TO THE MAXIMUM APPROVED PRESSURE OF YOUR PIPEWORK

HOSE NOZZLE MAX. 15 BAR

BOTTOM VIEW

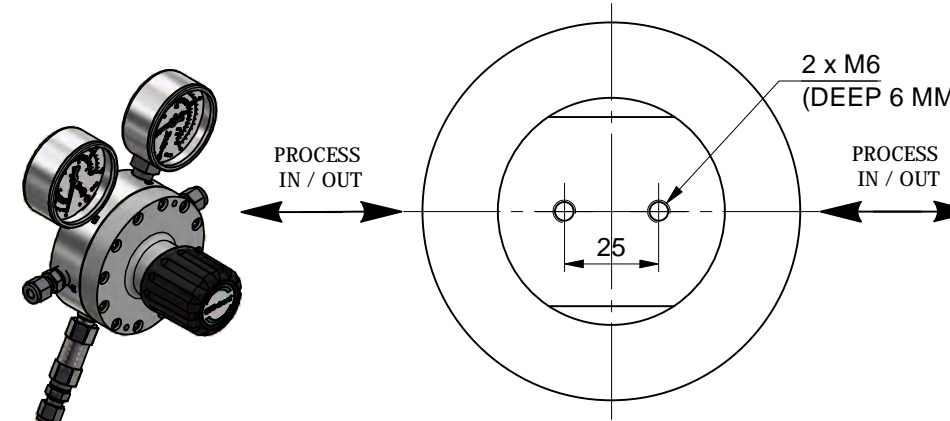

TECHNICAL SPECIFICATION

MATERIAL OF GAS WETTED PARTS:
REGULATOR BODY: BRASS (CW614N)
REGULATOR DIAPHRAGM: HASTELLOY (C276)
REGULATOR SEAL: PCTFE
REGULATOR SEAT: FKM
REGULATOR POPPET: BRASS (CW614N)

INLET PRESSURE: MAX. 40 BAR
FLOW NOMINAL: 5 Nm³/h (N₂)
ACC. TO ISO 7291 AT 3 BAR OUT

GAS TYPE
DEFINED BY PRODUCT LINE AND TYPE
(CHECK APPROVED GAS TYPE IN DATASHEET)

PUR LINE:
NON-CORROSIVE GASES
NON-TOXIC GASES

Polotovar Raw material	Rozm r polotovaru Dim. of raw material	Povrchovz +prava Surface finish	Hmotnost Weight
Materizl Material	Materizl Material	Star v kres Old drawing	2.82 kg
Komentz Notice	Kritick rozm r zna en Critical dimension marked	List / Po et list Sheet / Number of sheets	1 / 2
Datum vypracovz Creation date	Opracovz / Machining Ra	LINE-REG PUR-LINE LOW FLOW PV	
Vypracoval Created	Netol.rozm ry / Dim. without tol. ISO 2768 m,K	LINREG PUR 005Q PV S 6PORTJ 3IN 3OUT	
Kontroloval Inspected	M kko / Scale	GCE	
Schválil Approved		LPBPVSJ	
Klasifikace Item Class			

EXAMPLE: LPBPVSJRD1A4BTBTM06SM06S010001

VSTUP ZPRAVA - (JR)

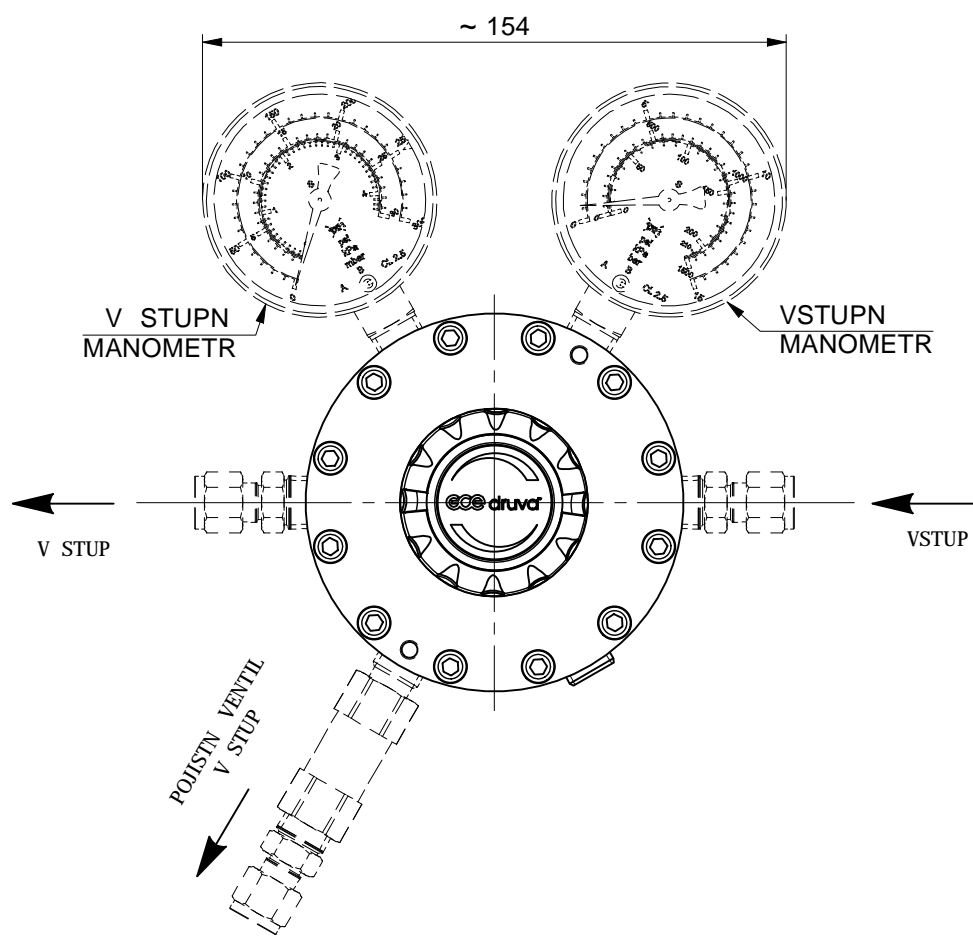

VSTUP ZLEVA - (JL)

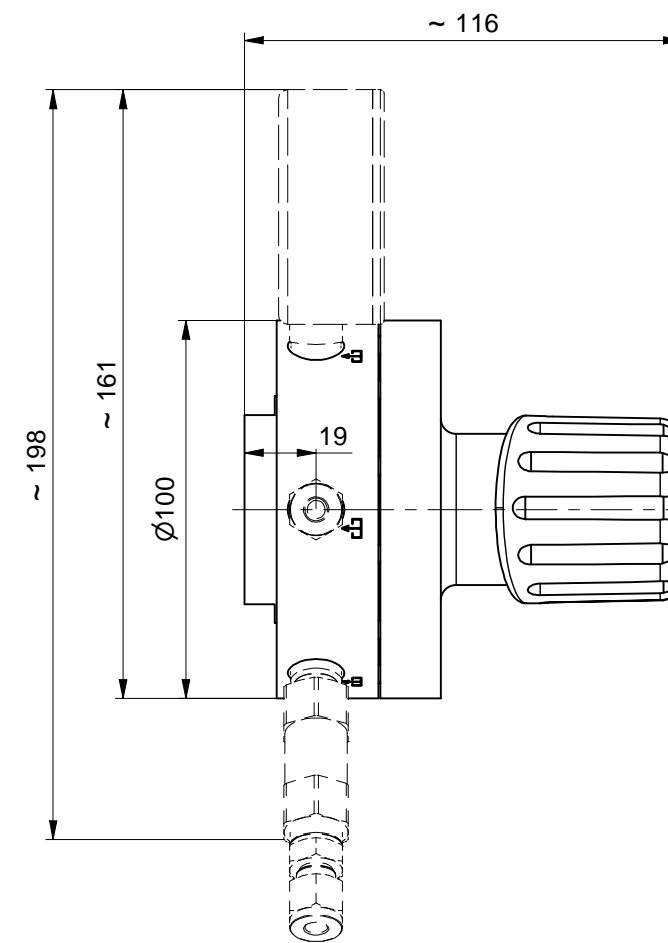
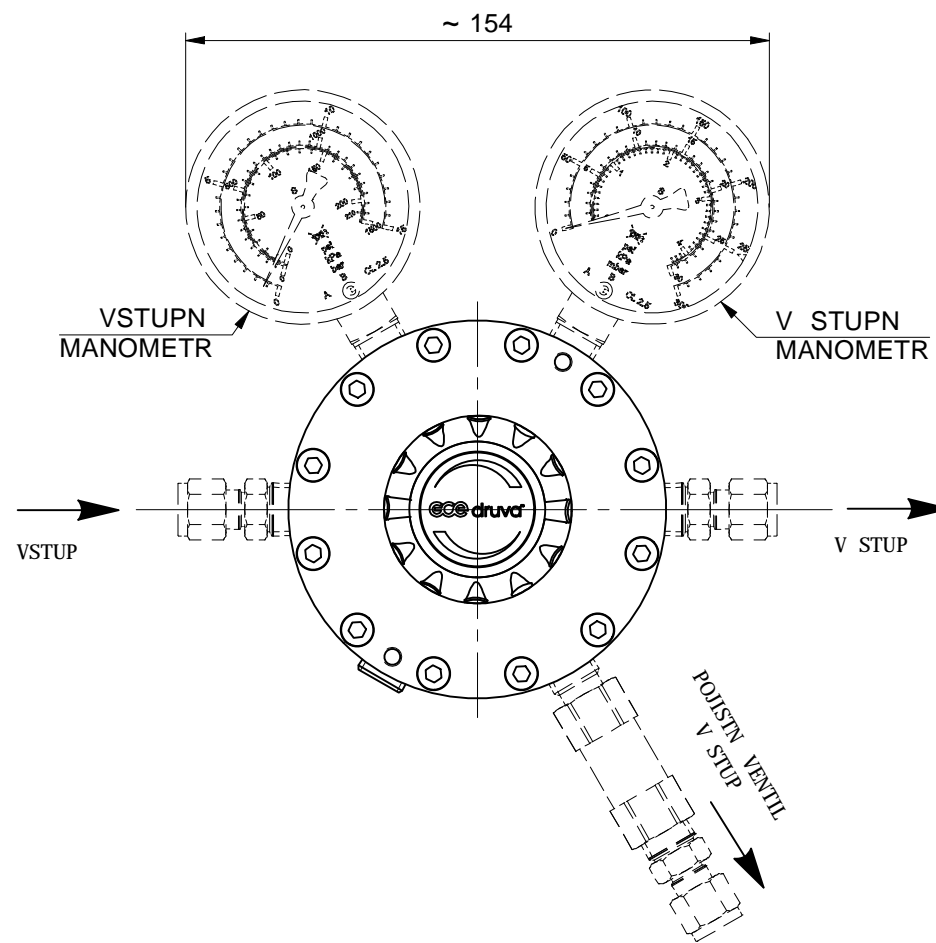

OBJEDNÁVKA - INFORMACE

LPBPVS JX XX XX XX XX XXXX XXXX XX XXXX

ORIENTACE PORTŮ:

R - VSTUP ZPRAVA
L - VSTUP ZLEVA

VSTUPNÁ TLAK:

D1 - 12 BAR
E1 - 40 BAR

V STUPNÁ TLAK:

A4 - 0,25 BAR
A3 - 0,45 BAR
A2 - 1,3 BAR
BX - 3 BAR (PRO VSTUPNÁ TLAK 40 BAR)

VSTUPNÁ MANOMETR:

00 - BEZ (NPT1/4") VNIT NĀ
01 - BEZ (ZĀTKA)
BT - BOURDONOVA TRUBICE

V STUPNÁ MANOMETR:

00 - BEZ (NPT1/4") VNIT NĀ
01 - BEZ (ZĀTKA)
BT - BOURDONOVA TRUBICE

P IPOJENĀ ZA POJISTKOU:

0001 - BEZ (ZĀTKA)
VIZ INFO - SEZNAM P IPOJENĀ

POJISTN VENTIL:

00 - BEZ (NPT1/4") VNIT NĀ
01 - BEZ (ZĀTKA)
RV - POJISTN VENTIL
(PRO V ST. TLAK 1,3 BAR / 3 BAR)

V STUPNĀ P IPOJENĀ:

N14F - NPT1/4" VNIT NĀ
M03S - KOMPRESNĀ P ĀPOJKA 3MM NEREZ
M06S - KOMPRESNĀ P ĀPOJKA 6MM NEREZ
M08S - KOMPRESNĀ P ĀPOJKA 8MM NEREZ
VIZ INFO - SEZNAM P IPOJENĀ

VSTUPNĀ P IPOJENĀ:

N14F - NPT1/4" VNIT NĀ
M03S - KOMPRESNĀ P ĀPOJKA 3MM NEREZ
M06S - KOMPRESNĀ P ĀPOJKA 6MM NEREZ
M08S - KOMPRESNĀ P ĀPOJKA 8MM NEREZ
VIZ INFO - SEZNAM P IPOJENĀ

SEZNAM P ĀPOJENĀ:

N14F - NPT1/4" VNIT NĀ
M03B - KOMPRESNĀ P ĀPOJKA 3MM MOSAZ
M06B - KOMPRESNĀ P ĀPOJKA 6MM MOSAZ
M08B - KOMPRESNĀ P ĀPOJKA 8MM MOSAZ
M10B - KOMPRESNĀ P ĀPOJKA 10MM MOSAZ
M12B - KOMPRESNĀ P ĀPOJKA 12MM MOSAZ
M03S - KOMPRESNĀ P ĀPOJKA 3MM NEREZ
M06S - KOMPRESNĀ P ĀPOJKA 6MM NEREZ
M08S - KOMPRESNĀ P ĀPOJKA 8MM NEREZ
M10S - KOMPRESNĀ P ĀPOJKA 10MM NEREZ
M12S - KOMPRESNĀ P ĀPOJKA 12MM NEREZ
IX2B - KOMPRESNĀ P ĀPOJKA 1/8" MOSAZ
IX4B - KOMPRESNĀ P ĀPOJKA 1/4" MOSAZ
IX6B - KOMPRESNĀ P ĀPOJKA 3/8" MOSAZ
IX8B - KOMPRESNĀ P ĀPOJKA 1/2" MOSAZ
IX2S - KOMPRESNĀ P ĀPOJKA 1/8" NEREZ
IX4S - KOMPRESNĀ P ĀPOJKA 1/4" NEREZ
IX6S - KOMPRESNĀ P ĀPOJKA 3/8" NEREZ
IX8S - KOMPRESNĀ P ĀPOJKA 1/2" NEREZ
H04B - HADIC. NĀST. 4.8 MM MOSAZ
H06B - HADIC. NĀST. 6.4 MM MOSAZ
H08B - HADIC. NĀST. 8.0 MM MOSAZ
H04S - HADIC. NĀST. 4.8 MM NEREZ
H06S - HADIC. NĀST. 6.4 MM NEREZ
H08S - HADIC. NĀST. 8.0 MM NEREZ

VOLBA MOSAZNĀ CH KOMPRESNĀCH P ĀPOJEK ZĀVISĀ NA TLAKU A VELIKOSTI.
V NUJTE POZORNĀST MAX. SCHVĀLENĀMU TLAKU V POTRUBĀ

HADICOVĀ NĀSTAVCE MAX. 15 BAR

POHLED ZESPODU

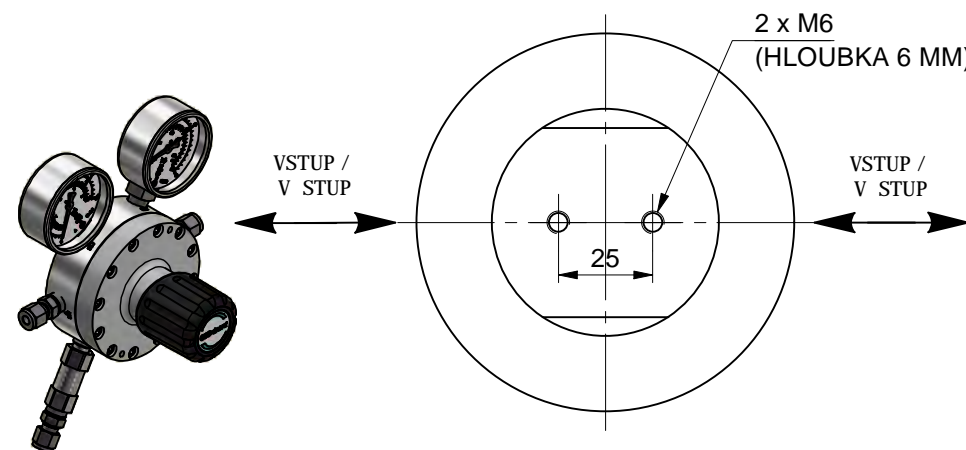

TECHNICKĀ SPECIFIKACE

MATERIĀL POLOBEK VE STYKU S PLYNEM:
T LESO: MOSAZ (CW614N)
MEMBRĀNA: HASTELLOY (C276)
T SN NĀ PCTFE
SEDLO RED. VENTILU: FKM
KUPELKA: MOSAZ (CW614N)

VSTUPNĀ TLAK: MAX. 40 BAR
JMENOVI PR TOK: 5 m³/h (N₂)
DLE ISO 7291 P 1 3 BAR NA V STUPU

TYP PLYNU
DEFINOVĀN PRODUKTOVOU ADOU A TYPEM
(KONTROLUJ SCHVĀLENĀ TYP PLYNU
V KAT. LISTU)

ADA PUR:
PRO NEKOROZIVNĀ PLYNU
PRO NETOXICKĀ PLYNU

Polotovar Raw material	Rozm r polotovaru Dim. of raw material	Povrchov Ārava Surface finish	Hmotnost Weight	2.82 kg
MateriĀl Material	MateriĀl Material	Star v kres Old drawing	List / Po et list Sheet / Number of sheets	2 / 2
KomentĀr Notice	kritick rozm r zna en Critical dimension marked	KR		
Datum vypracovĀnĀ Creation date	27.04.2020	OpracovĀnĀ / Machining Ra	Netol.rozm ry / Dim. without tol. ISO 2768 m,K	
VypracovĀl Created	Ondracek Lubos			
KontrolovĀl Inspected	P. Novotny			
SchvĀlil Approved	Dr. Th. Kuester	M Āko / Scale		
Klasifikace Item Class	B: Standard	1:2		

LINE-REG PUR-LINE LOW FLOW PV
LINREG PUR 005Q PV S 6PORTJ 3IN 3OUT



LPBPVSJ

P ĀKLAD: LPBPVSJRD1A4BTBTM06SM06S010001